

# THE SAFFIRE JEWEL

A sanctuary shaped by sea and stone  
Opening Late 2026



Saffire

OPENING LATE 2026

✉ [stay@saffire-freycinet.com.au](mailto:stay@saffire-freycinet.com.au)

+61 3 6256 7888



## WHERE TIME SLOWS, WONDER BEGINS

Hidden within Tasmania's wild coastline, The Saffire Jewel Private Villa presents a rare sanctuary where the grandeur of nature meets the intimacy of home. Born of the ancient pink granite of The Hazards, framed by native bushland and overlooking the endless sweep of Great Oyster Bay, this villa is designed for those who seek not just luxury, but meaning.

## VILLA FEATURES

- **Private arrival** through tranquil gardens and a reflection pond, setting the tone for stillness and anticipation
- **Three master suites**, each a haven of privacy and calm, designed for togetherness and retreat
- **Over 800m<sup>2</sup>** of seamless indoor-outdoor living, where boundaries dissolve and nature flows in
- **Interiors of distinction**, with charred timber, travertine, local rock and gem features, marble and bespoke Tasmanian art, each texture tells a story of land and light
- **Infinity pool, jacuzzi and a fire-pit terrace retreat** with panoramic bay views, inviting renewal and reflection
- **Elevated experiences** including in-villa breakfast, dedicated luxury concierge team, private guide, premium beverages, plus curated dining experiences with a private chef, and sunset canapés for longer stays.

## THE COMPLETE SAFFIRE EXPERIENCE, AND MORE

Choosing the Saffire Jewel means you enjoy every hallmark of the Saffire Freycinet experience, with the added benefit of being able to retreat together to your own private sanctuary. Guests of the villa have full access to Saffire's world-class service and hospitality within the main lodge and all immersive experiences. From intuitive staff who anticipate your needs, to the honesty of quality local food and the quiet theatre of nature, nothing is missed.

Whether you're enjoying Saffire's Signature Experiences, exploring the landscape with expert guides, or relaxing in the jacuzzi, you remain part of the Saffire story. The villa simply adds a new layer of premium privacy, space and exclusivity for families and small groups.

SECLUSION,  
PERFECTED  
THROUGH  
DESIGN



## THE GUEST EXPERIENCE

Your journey begins in stillness – water rippling at the reflection pond, the hush of bushland all around. The villa reveals itself in layers – sunlight through glass, stone underfoot, art curated along the gallery corridor. Days unfold effortlessly – coffee at sunrise, long lunches curated for you, laughter echoing from the infinity pool, evenings by the fire beneath the southern stars.

At the Saffire Jewel, every detail is conceived to dissolve distraction and immerse you wholly in people, place and presence. This is luxury that lingers, a rare clarity that endures long after you depart.



AN ICON IN  
THE MAKING:  
THE SAFFIRE  
JEWEL AT  
SAFFIRE

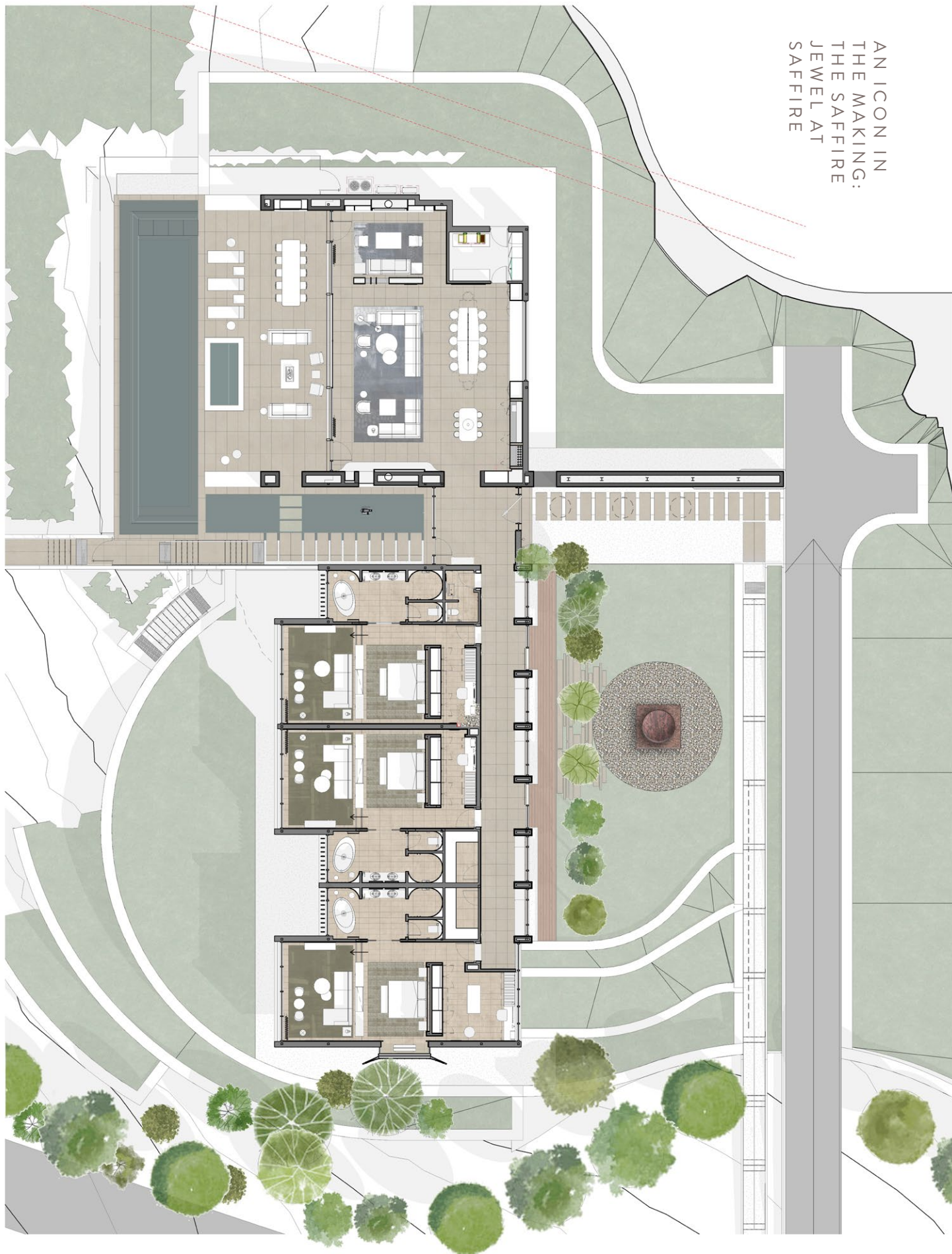

Saffire

OPENING LATE 2026

✉ [stay@saffire-freycinet.com.au](mailto:stay@saffire-freycinet.com.au)

+61 3 6256 7888